

Personal Hotspot Explained

Hotspots offer more convenient capability than tethering, where a data connection is shared with a single computer using a USB cable or Bluetooth. Just as the iPhone can be used as a Wi-Fi hotspot, many Android smartphones and tablets offer similar features. With a Wi-Fi hotspot, your mobile data connection on your Android device can be shared wirelessly with up to five other devices, including other cell phones, tablets, and computers. The Wi-Fi data-sharing feature is built into most Android devices

Personal Hotspot Requirements

To use Personal Hotspot on an Android phone, you'll need:

1. An **Android** phone that supports Hotspot
2. A data plan that supports tethering or Personal Hotspot.
3. A USB cable, if you want to connect devices that way.

Add Personal Hotspot to Your Data Plan

Most major phone companies include Personal Hotspot by default as part of their data plans. AT&T and Verizon include it on all their plans, while T-Mobile offers it as part of its unlimited data plan. Sprint charges for it, with prices depending on how much data you want to use.

Most regional carriers and pay-as-you-go carriers support Personal Hotspot as part of their data plans, as well. If you're not sure whether you have Personal Hotspot on your data plan, check with your phone company.

Turn On the Portable Wi-Fi Hotspot Feature on Your Samsung Smartphone

If you aren't restricted from using the Wi-Fi hotspot feature on your Android device, enable it.

Be selective when using a smartphone as a Wi-Fi hotspot, and with whom you share the password. Data processed through this Wi-Fi feature uses your monthly allotment of mobile data usage.

To turn on the Wi-Fi hotspot:

1. Go to Settings on your Samsung phone. From the **Home** screen, press the **Menu** button, then tap **Settings**.

2. In the **Settings** screen, tap **Wireless & networks**. On a Samsung phone, tap **Connections**, then tap **Mobile Hotspot and Tethering**.
3. Turn on the **Mobile Hotspot** toggle switch. The phone becomes a wireless access point and displays a message in the notification bar when it's activated.

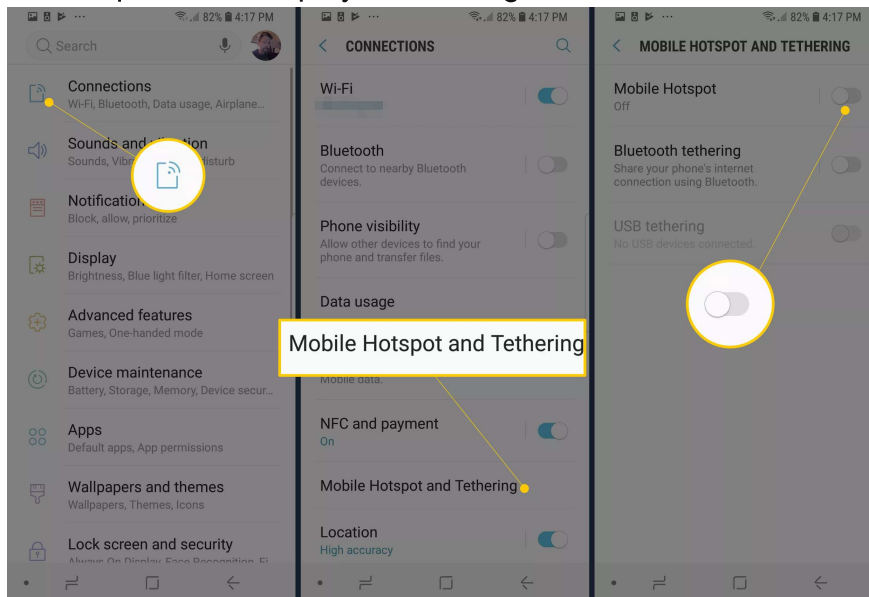

4. To find the password and instructions for the hotspot, tap **Mobile Hotspot**. Use this password to connect your other devices to the hotspot.
Tip: To change the default password, tap **Password** and enter a new password.
5. Connect your other devices to the hotspot to go online.

Turn On the Portable Wi-Fi Hotspot Feature on Your Pixel or Stock Android Smartphone

If you aren't restricted from using the Wi-Fi hotspot feature on your Android device, enable it:

1. Launch the **Settings** app, then tap **Network & Internet**.
2. Tap **Hotspot & tethering**, then tap **Wi-Fi hotspot**.

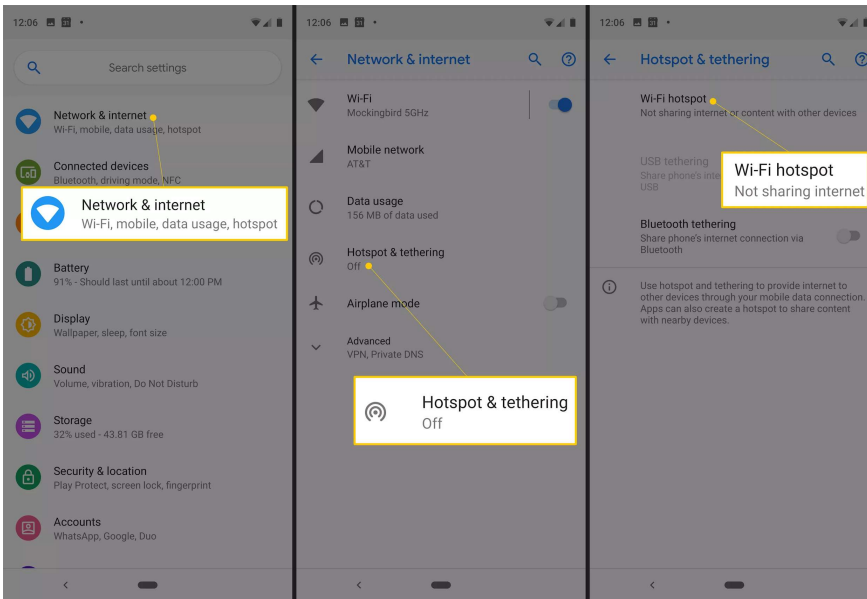

3. Turn on the **Wi-Fi hotspot** toggle switch.

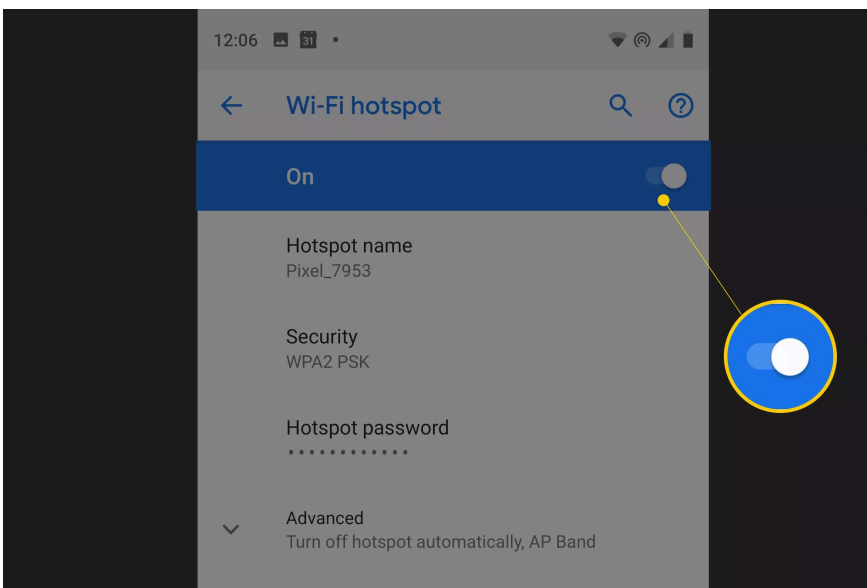

4. Optionally, change the hotspot name, password, and other advanced settings such as automatic shutoff and the AP Band.

Find and Connect to the New Wi-Fi Hotspot Created

When the hotspot is activated, connect your other devices to it as if it were any other Wi-Fi router:

1. From each device with which you want to share Internet access, find the Wi-Fi hotspot. Your computer, tablet, or other smartphones may notify you that new wireless networks are available.

Note: To find the wireless networks, use your Android phone and go to **Settings > Wireless & networks > Wi-Fi settings**. Then, follow the general Wi-Fi connection instructions for most computers.

2. Establish the connection by entering the password for the Wi-Fi hotspot.

Tips and Considerations

When using the Wi-Fi hotspot on your Android phone and other devices, follow these recommendations:

1. Turn off the Wi-Fi hotspot feature when you no longer need shared Internet access for other devices. Leaving the feature activated drains the cell phone battery.
2. By default, portable Wi-Fi hotspots are set up with WPA2 security and a generic password. If you use a hotspot in a public place or are concerned about hackers intercepting your data, change the password before broadcasting your signal.
3. Different devices and carriers use different methods to activate the mobile hotspot feature. Some carriers require the use of a stand-alone app, instead of the stock Android capability, to share your data plan with Wi-Fi users. Check the specific instructions for your device manufacturer or your service provider.
4. Personal Hotspot uses data from your phone data plan, which offers a limited amount of data. Your monthly data allowance can be used up quickly when streaming video or doing other bandwidth-intensive tasks.
5. All data used by devices connected to your phone counts against your data plan, so be careful if your data plan is small. Learn how to check your data usage so you don't accidentally go over your limit.

Source: <https://www.lifewire.com/use-your-android-phone-as-a-portable-wi-fi-hotspot-2377915>